

# hear back OCTO™

## 8-CHANNEL MONITOR MIXER SYSTEM

### QUICK START GUIDE



SCAN  
CODE  
FOR USER  
GUIDE

Thank you for purchasing the Hear Back OCTO 8-channel personal monitor mixer system! Use this *Quick Start Guide* to setup quickly and easily. Refer to the *User Guide* for complete instructions, available online at [www.heartechnologies.com](http://www.heartechnologies.com) or scan the QR code above.

### CONNECTING THE SYSTEM

- 1 Connect the appropriate input(s) as shown in the hook-up diagram.
- 2 Select the desired input using the front panel switch.
- 3 Connect Hear Back OCTO Mixers to the Hear Back OCTO Hub Mixer Outputs using CAT6\* or CAT5e cables.
- 4 Set all Mixer Channels and Master Volume levels to “Off” (full counter-clock-wise position).
- 5 Connect the headphones, in-ear monitors, and/or line outputs for connecting to wireless in-ear systems, powered monitors, or other devices requiring line-level inputs.
- 6 Apply power to the Hub.

### ⚠ WARNING

- The Hear Back OCTO is capable of driving most headphones to extreme levels that can damage your HEARING!
- ALWAYS turn down the Mixer “Master” volume down before putting on in-ear headsets or headphones.

### HOOK-UP DIAGRAM

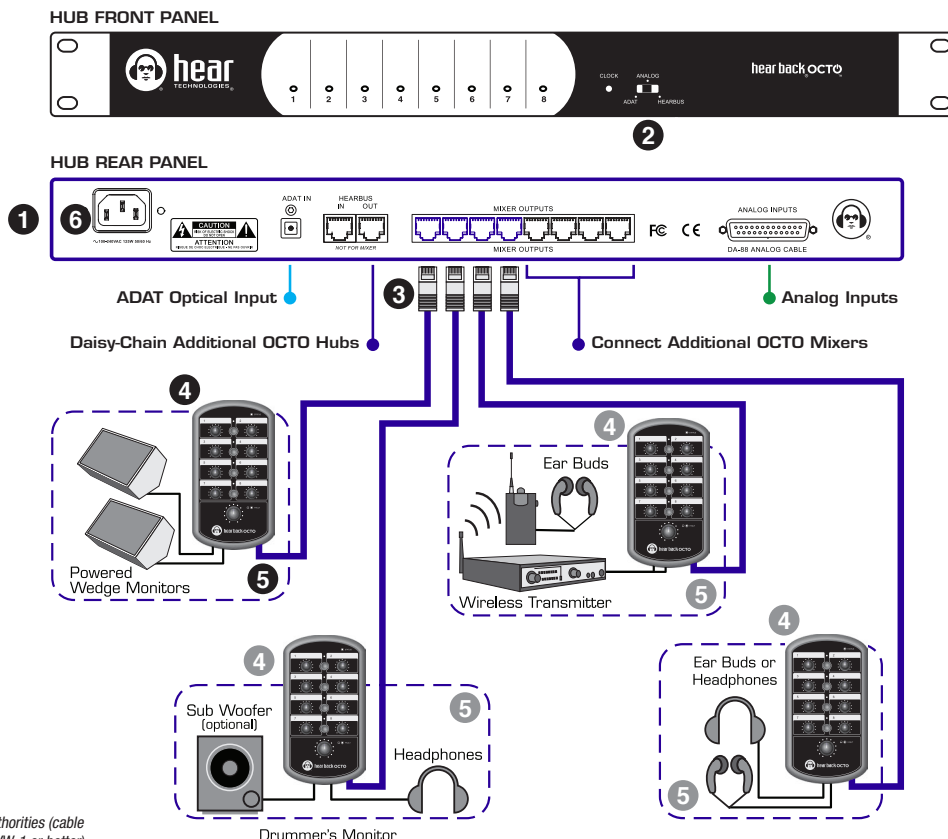

\*Cable complying with the National authorities (cable with an outer jacket or sleeving rated VW-1 or better).



Hear Back OCTO is proudly designed & assembled in the U.S.A. by musicians and audio engineers.

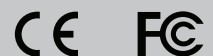

## HUB DETAIL

- 1 - Audio Input Channels 1-8  
Level LED Metering
- 2 - HearBus Clock Status Indicator
- 3 - Input Selector Switch
- 4 - AC Power Input
- 5 - ADAT Optical Input
- 6 - HearBus Input
- 7 - HearBus Output
- 8 - Hear Back OCTO Mixer Outputs
- 9 - Analog Inputs

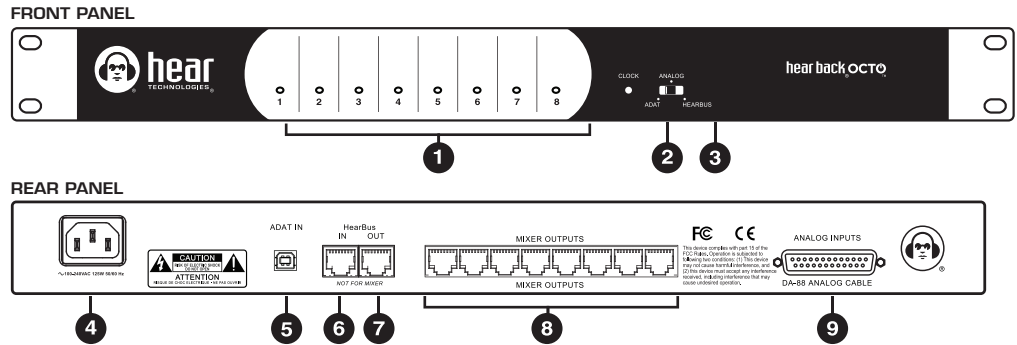

## MIXER DETAIL

- 10 - Bi-Color Bus Status Indicator
- 11 - Link Indicators (Channels 1/2, 3/4, 5/6, 7/8)
- 12 - Mono Channels 1-8 /Stereo Link Master Level (1, 3, 5, 7)
- 13 - Headphone Amplifier Fault Indicator
- 14 - Master Volume
- 15 - Left/Mono Line Output
- 16 - Right Line Output
- 17 - 1/8" TRS Headphone Output
- 18 - 1/4" TRS Headphone Output
- 19 - Stereo Auxiliary Input
- 20 - RJ45 Connection

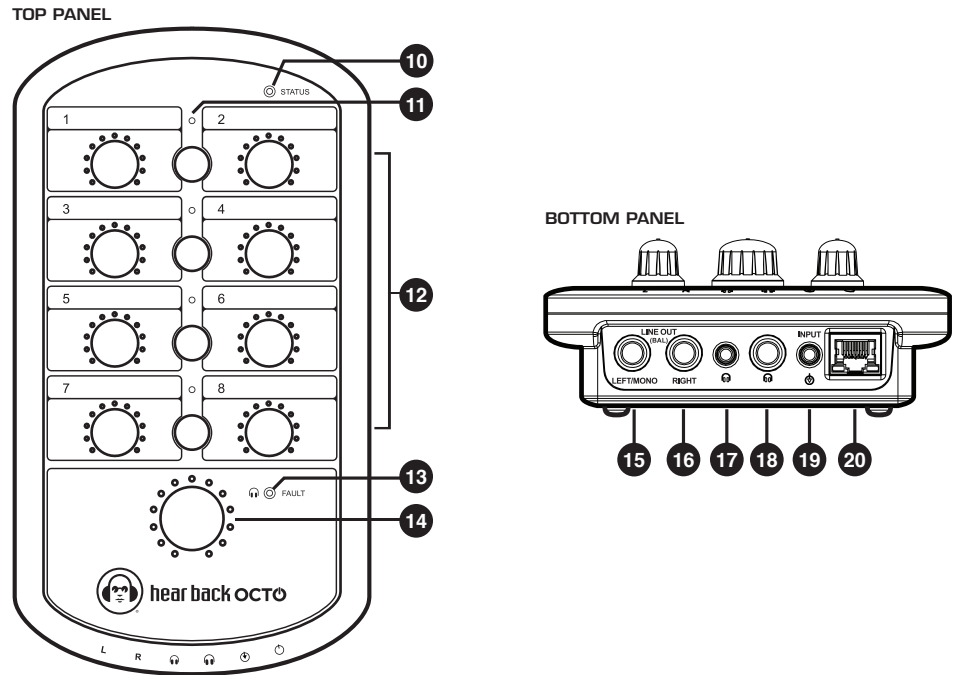

## HUB ADJUSTMENT

- A. Adjust the level at the input source (DAW, Mixer, etc.) until the clip LED's **1** on the Hub just come on and then reduce the input(s) until you have a bright blue LED.
- B. Adjust the source for as much signal into the Hub as possible without clipping. Higher input levels improve signal-to-noise and dynamic range.

## MIXER ADJUSTMENT

- A. After you have the signals optimized on the Hub, turn the "Master" Volume **14** up to about 10 o'clock
- B. Raise each channel's volume **12** to a comfortable level.
- C. Avoid adjusting the master volume too high and running the inputs too low.

## LINK OPERATION

- D. To stereo-link any channels, press the capacitive button **11** between adjacent channels (1/2, 3/4, 5/6, 7/8) for one second to hard pan those channels left-right. The blue LED above the link button will illuminate verifying the link. The left channel knob becomes the link master volume control for the stereo pair. The right channel knob now becomes inactive. Button settings are stored in flash memory when power is removed.

## LINE OUTPUTS

- E. Left/Mono **15** and Right/Stereo **16** line outputs are 1/4" balanced TRS jacks. **When the Left/Mono jack only is used, left and right are summed as a mono output.** The line outputs may be used with the headphone outputs and both are controlled by the master volume.

## AUX IN ADJUSTMENT

- F. If using an auxiliary input, connect it to the Mixer via the 1/8" stereo TRS "INPUT" **19**. Tip is left, Ring is right, and Sleeve is ground. The aux in is controlled by the master volume only. Adjust the input source to properly mix with the channel levels.

## MASTER VOLUME ADJUSTMENT

- G. Adjust the "Master" Volume **14** to set the volume of the headphones and the line outputs. When using the line outputs in conjunction with the headphones, optimize the mix for the headphones and then adjust the device connected to the line outputs to balance the gain.

## HEADPHONE AMPLIFIER

- H. The 1/8" and 1/4" headphone amplifier outputs **17** and **18** are paralleled outputs. When using multiple headsets, total impedance should not go below 16 ohms. Optimum headphone amplifier performance is achieved with a load of 32 to 50 ohms.



Hear Technologies®  
991 Discovery Drive  
Huntsville, AL 35806

www.HearTechnologies.com  
Phone: 1-256-922-1200  
Fax: 1-256-922-1221

Printed in U.S.A. ©2019  
OCT 2024